



NOTES:

1. THIS PLAT IS THE RESULT OF A CURRENT FIELD SURVEY.
2. THIS PLAT WAS PREPARED WITHOUT THE BENEFIT OF A CURRENT TITLE REPORT.
3. SUBJECT PROPERTY AS SHOWN IS ALL OF CARROLL COUNTY TAX SECTION 58-41, PARCEL 4.
4. SUBJECT PROPERTY AS SHOWN DOES NOT FALL WITHIN THE LIMITS OF A FLOOD DESIGNATED FLOOD HAZARD ZONE. THIS OPINION IS BASED UPON A COMMUNITY PLANE 45103032002 (ZONE X) AND HAS NOT BEEN FIELD VERIFIED.
5. CORNERS NOT DESCRIBED ARE POINTS LOCATED ALONG CENTERLINE OF R/W.
6. OWNER AND DEVELOPER: TURMAN & BOLT, P.O. BOX 497, FLOYD VA 24091
7. THE USE OF THESE LOTS SHALL BE FOR RESIDENTIAL PURPOSES.
8. 35 MINIMUM BUILDING LINE FROM RIGHT-OF-WAYS AND 15' FROM SIDE AND REAR FROM RIGHT-OF-WAYS.
9. 10' PUBLIC UTILITY EASEMENT LINE FROM RIGHT-OF-WAYS.
10. PURSUANT TO CARROLL COUNTY CODE SECTION 113-280, THIS PLAT IS NOT TO BE CONSIDERED NEAR APPROVED FOR ON-SITE WATER OR SEPTIC.

THIS PLAT CONFORMS TO THE CURRENT CARROLL COUNTY SUBDIVISION ORDINANCE.

GRAPHIC SCALE - FEET
0 200 400 600

SURVEYOR'S CERTIFICATE

I HEREBY CERTIFY THAT THIS SURVEY, TO THE BEST OF MY KNOWLEDGE AND BELIEF, IS IN ACCORDANCE WITH THE REQUIREMENTS OF THE CARROLL COUNTY SUBDIVISION ORDINANCES AND REGULATIONS REGARDING THE PLATING OF SUBDIVISIONS WITHIN THE COUNTY OF CARROLL, VIRGINIA. GIVEN UNDER MY HAND THIS ____ DAY OF ____ 2010.

L. L. QUESSENBERRY, L.S. #1270

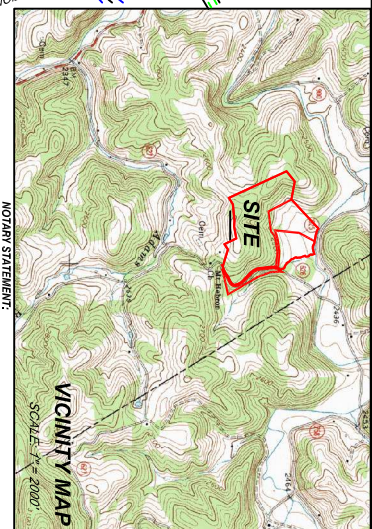

NOTARY STATEMENT:

A NOTARY PUBLIC IN AND FOR THE COMMONWEALTH OF VIRGINIA, COUNTY OF CARROLL, DO HEREBY CERTIFY THAT I HAVE PERSONALLY KNOWN AND ACKNOWLEDGED THE SIGNER IN MY COUNTY AND STATE AS PERSONS, GIVEN UNDER MY HAND ON THIS ____ DAY OF ____ 2010.

MY COMMISSION EXPIRES

NOTARY PUBLIC

CERTIFICATE OF APPROVAL:

THIS SUBDIVISION IS APPROVED BY THE UNDERSIGNER IN ACCORDANCE WITH THE EXISTING SUBDIVISION ORDINANCES AND REGULATIONS AND MAY BE COMMITTED TO RECORD.

AGENT OF GOVERNING BODY

DATE

DATE

DATE

DATE

DATE

DATE

DATE

DATE

DATE

DATE

DATE

DATE

DATE

DATE

DATE

DATE

DATE

DATE

DATE

DATE

DATE

DATE

DATE

DATE

DATE

DATE

Course	Bearing	Distance
1-2	S 47°15'45" E	43.86'
2-3	S 60°05'34" E	56.59'
3-4	S 67°40'04" E	64.10'
4-5	S 73°05'59" E	140.34'
5-6	S 73°05'59" E	38.66'
6-7	S 69°33'51" E	90.49'
7-8	S 81°28'08" E	53.31'
8-9	S 81°36'32" E	108.50'
9-10	S 87°54'20" E	13.05'
10-11	S 03°56'11" W	14.15'
11-12	S 22°06'33" E	31.25'
12-13	S 15°16'12" W	28.72'
13-14	S 19°04'12" E	28.83'
14-15	S 48°53'56" E	34.70'
15-16	S 01°38'55" W	61.42'
16-17	S 33°34'01" W	71.16'
17-18	S 72°40'01" W	11.29'
18-19	S 13°33'49" E	38.20'
19-20	S 18°16'12" E	30.85'
20-21	S 04°55'57" W	50.85'
21-22	S 03°33'05" E	28.75'
22-23	S 38°56'12" W	21.61'
23-24	S 06°22'15" E	32.24'
24-25	S 28°05'37" E	54.00'
25-26	S 11°50'33" W	29.05'
26-27	S 34°03'41" E	42.31'
27-28	S 38°56'09" E	46.59'
28-29	S 24°56'56" E	65.21'
29-30	S 64°43'32" E	18.90'
30-31	S 43°58'05" E	41.33'
31-32	S 63°14'30" E	63.64'
32-33	S 23°05'24" E	31.22'
33-34	S 04°08'05" W	25.89'
34-35	S 26°43'09" E	36.08'
35-36	S 37°26'53" W	70.95'
36-37	Road: 266.46'	Ang: 28.10'
37-38	Road: 145.57'	Ang: 7.03°00'
38-39	Chd: S 33°52'23" W	243.05'
39-40	Chd: S 24°08'41" W	51.51'
40-41	Chd: S 24°08'41" W	51.51'
41-42	Road: 236.46'	Ang: 62.49'
42-43	Chd: S 10°19'15" W	62.31'
43-44	S 02°45'01" W	48.63'
44-45	S 04°04'22" W	151.33'
45-46	Road: 35.196'	Ang: 263.17'
46-47	Road: 38.106'	Ang: 42°50'28"
47-48	Chd: S 17°20'52" E	257.09'
48-49	S 38°46'06" E	250.24'
49-50	S 26°30'08" E	54.66'
50-51	Road: 217.88'	Ang: 122.84'
51-52	Chd: S 10°21'05" W	112.00'
52-53	Road: 39.899'	Ang: 36.10'
53-54	Chd: S 10°21'05" W	112.00'
54-55	Road: 39.899'	Ang: 36.10'
55-56	Chd: S 10°21'05" W	112.00'
56-57	Road: 39.899'	Ang: 36.10'
57-58	Chd: S 10°21'05" W	112.00'
58-59	Road: 39.899'	Ang: 36.10'
59-60	Chd: S 10°21'05" W	112.00'
60-61	Road: 39.899'	Ang: 36.10'
61-62	Chd: S 10°21'05" W	112.00'
62-63	Road: 39.899'	Ang: 36.10'
63-64	Chd: S 10°21'05" W	112.00'
64-65	Road: 39.899'	Ang: 36.10'
65-66	Chd: S 10°21'05" W	112.00'
66-67	Road: 39.899'	Ang: 36.10'
67-68	Chd: S 10°21'05" W	112.00'
68-69	Road: 39.899'	Ang: 36.10'
69-70	Chd: S 10°21'05" W	112.00'
70-71	Road: 39.899'	Ang: 36.10'
71-72	Chd: S 10°21'05" W	112.00'
72-73	Road: 39.899'	Ang: 36.10'
73-74	Chd: S 10°21'05" W	112.00'
74-75	Road: 39.899'	Ang: 36.10'
75-76	Chd: S 10°21'05" W	112.00'
76-77	Road: 39.899'	Ang: 36.10'
77-78	Chd: S 10°21'05" W	112.00'
78-79	Road: 39.899'	Ang: 36.10'

LEGEND

- x—x— Force
- y—y— Adjacent
- z—z— Minimum Building
- MSL--- Submerge Line

56.751 AC.

14.919 AC.

11.327 AC.

82.997 AC. TOTAL

TURMAN & BOLT

ADAMS BRANCH ROAD

LOCATED ON VIRGINIA SECONDARY ROUTE 4626

PLAT SHOWING A STANDARD SUBDIVISION

PROPERTY OF

ADAMS BRANCH ROAD

LOCATED ON VIRGINIA SECONDARY ROUTE 4626

PLAT SHOWING A STANDARD SUBDIVISION

PROPERTY OF

ADAMS BRANCH ROAD

LOCATED ON VIRGINIA SECONDARY ROUTE 4626

PLAT SHOWING A STANDARD SUBDIVISION

PROPERTY OF

ADAMS BRANCH ROAD

LOCATED ON VIRGINIA SECONDARY ROUTE 4626

PLAT SHOWING A STANDARD SUBDIVISION

PROPERTY OF

ADAMS BRANCH ROAD

LOCATED ON VIRGINIA SECONDARY ROUTE 4626

PLAT SHOWING A STANDARD SUBDIVISION

PROPERTY OF

ADAMS BRANCH ROAD

LOCATED ON VIRGINIA SECONDARY ROUTE 4626

PLAT SHOWING A STANDARD SUBDIVISION

PROPERTY OF

ADAMS BRANCH ROAD

LOCATED ON VIRGINIA SECONDARY ROUTE 4626

PLAT SHOWING A STANDARD SUBDIVISION

PROPERTY OF

ADAMS BRANCH ROAD

LOCATED ON VIRGINIA SECONDARY ROUTE 4626

PLAT SHOWING A STANDARD SUBDIVISION

PROPERTY OF

ADAMS BRANCH ROAD

LOCATED ON VIRGINIA SECONDARY ROUTE 4626

PLAT SHOWING A STANDARD SUBDIVISION

PROPERTY OF

ADAMS BRANCH ROAD

LOCATED ON VIRGINIA SECONDARY ROUTE 4626

PLAT SHOWING A STANDARD SUBDIVISION

PROPERTY OF

ADAMS BRANCH ROAD

LOCATED ON VIRGINIA SECONDARY ROUTE 4626

PLAT SHOWING A STANDARD SUBDIVISION

PROPERTY OF

ADAMS BRANCH ROAD

LOCATED ON VIRGINIA SECONDARY ROUTE 4626

PLAT SHOWING A STANDARD SUBDIVISION

PROPERTY OF

ADAMS BRANCH ROAD

LOCATED ON VIRGINIA SECONDARY ROUTE 4626

PLAT SHOWING A STANDARD SUBDIVISION

PROPERTY OF

ADAMS BRANCH ROAD

LOCATED ON VIRGINIA SECONDARY ROUTE 4626

PLAT SHOWING A STANDARD SUBDIVISION

PROPERTY OF

ADAMS BRANCH ROAD

LOCATED ON VIRGINIA SECONDARY ROUTE 4626

PLAT SHOWING A STANDARD SUBDIVISION

PROPERTY OF

ADAMS BRANCH ROAD

LOCATED ON VIRGINIA SECONDARY ROUTE 4626

PLAT SHOWING A STANDARD SUBDIVISION

PROPERTY OF

ADAMS BRANCH ROAD

LOCATED ON VIRGINIA SECONDARY ROUTE 4626

PLAT SHOWING A STANDARD SUBDIVISION

PROPERTY OF

ADAMS BRANCH ROAD

LOCATED ON VIRGINIA SECONDARY ROUTE 4626

PLAT SHOWING A STANDARD SUBDIVISION

PROPERTY OF

ADAMS BRANCH ROAD

LOCATED ON VIRGINIA SECONDARY ROUTE 4626

PLAT SHOWING A STANDARD SUBDIVISION

PROPERTY OF

ADAMS BRANCH ROAD

LOCATED ON VIRGINIA SECONDARY ROUTE 4626

PLAT SHOWING A STANDARD SUBDIVISION

PROPERTY OF

ADAMS BRANCH ROAD

LOCATED ON VIRGINIA SECONDARY ROUTE 4626

PLAT SHOWING A STANDARD SUBDIVISION

PROPERTY OF

ADAMS BRANCH ROAD

LOCATED ON VIRGINIA SECONDARY ROUTE 4626

PLAT SHOWING A STANDARD SUBDIVISION

PROPERTY OF

ADAMS BRANCH ROAD

LOCATED ON VIRGINIA SECONDARY ROUTE 4626

PLAT SHOWING A STANDARD SUBDIVISION

PROPERTY OF

ADAMS BRANCH ROAD

LOCATED ON VIRGINIA SECONDARY ROUTE 4626

PLAT SHOWING A STANDARD SUBDIVISION

PROPERTY OF

ADAMS BRANCH ROAD

LOCATED ON VIRGINIA SECONDARY ROUTE 4626

PLAT SHOWING A STANDARD SUBDIVISION

PROPERTY OF

ADAMS BRANCH ROAD

LOCATED ON VIRGINIA SECONDARY ROUTE 4626

PLAT SHOWING A STANDARD SUBDIVISION

PROPERTY OF

ADAMS BRANCH ROAD

LOCATED ON VIRGINIA SECONDARY ROUTE 4626

PLAT SHOWING A STANDARD SUBDIVISION

PROPERTY OF

ADAMS BRANCH ROAD

LOCATED ON VIRGINIA SECONDARY ROUTE 4626

PLAT SHOWING A STANDARD SUBDIVISION

PROPERTY OF

ADAMS BRANCH ROAD

LOCATED ON VIRGINIA SECONDARY ROUTE 4626

PLAT SHOWING A STANDARD SUBDIVISION

PROPERTY OF

ADAMS BRANCH ROAD

LOCATED ON VIRGINIA SECONDARY ROUTE 4626

PLAT SHOWING A STANDARD SUBDIVISION

PROPERTY OF

ADAMS BRANCH ROAD

LOCATED ON VIRGINIA SECONDARY ROUTE 4626

PLAT SHOWING A STANDARD SUBDIVISION

PROPERTY OF

ADAMS BRANCH ROAD

LOCATED ON VIRGINIA SECONDARY ROUTE 4626

PLAT SHOWING A STANDARD SUBDIVISION

PROPERTY OF

ADAMS BRANCH ROAD

LOCATED ON VIRGINIA SECONDARY ROUTE 4626

PLAT SHOWING A STANDARD SUBDIVISION

PROPERTY OF

ADAMS BRANCH ROAD

LOCATED ON VIRGINIA SECONDARY ROUTE 4626

PLAT SHOWING A STANDARD SUBDIVISION

PROPERTY OF

ADAMS BRANCH ROAD

LOCATED ON VIRGINIA SECONDARY ROUTE 4626

PLAT SHOWING A STANDARD SUBDIVISION

PROPERTY OF

ADAMS BRANCH ROAD

LOCATED ON VIRGINIA SECONDARY ROUTE 4626